

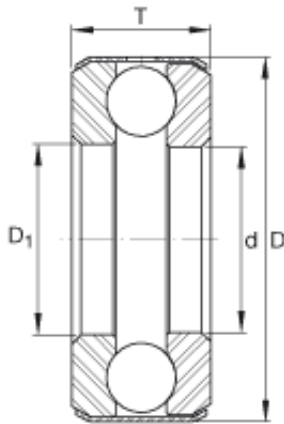

EDB BEARING CORP.



RSL18 2232 Full Complement Cylindrical Roller Bearing (Without Cup) 160x266.36x80mm

Bearing No. D35

D35 Bearing 2D drawings and 3D CAD models

Size	66.675x110.338x25.4 mm
Bore Diameter	66,675 mm
Outer Diameter	110,338 mm
Width	25,4 mm
d	2 5/8 inch
d	66,675 mm
D	4,344 inch
D	110,338 mm
T	1 inch
T	25,4 mm
D ₁	2,656 inch
m	1,95 lbs / Weight
m	886 g / Weight
C _a	18100 lbf / Dynamic load rating (axial)
C _a	81000 N / Dynamic load rating (axial)
C _{0a}	49000 lbf / Static load rating (axial)
C _{0a}	218000 N / Static load rating (axial)
Category	Thrust Ball Bearing
Inventory	0.0
Manufacturer Name	SCHAEFFLER GROUP
Minimum Buy Quantity	N/A
Weight / Kilogram	1.06
EAN	4047643199292



EDB BEARING CORP.

Product Group	B00308
Rolling Element	Ball Bearing
Thrust Bearing	Yes
Single or Double Direction	Single Direction
Banded	Yes
Precision Class	ABEC 1 ISO P0
Component Description	Roller Assembly Plus Raceways
Other Features	Single Row Deep Groove Medium Cross Section Grooved Race Non Separable Full Complement Standard Oil Hole in Band
Long Description	2-5/8" Bore 1; 2-21/32" Bore 2; 4-11/32" Outside Diameter; 1" Height; Ball Bearing; Single Direction; Banded; ABEC 1 ISO P0 Precision
Inch - Metric	Inch
Category	Thrust Ball Bearings
UNSPSC	31171507
Harmonized Tariff Code	8482.10.50.08
Noun	Bearing
Keyword String	Ball Thrust
Manufacturer URL	http://www.ina.com
Manufacturer Item Number	D35HLG
Weight / LBS	1.95
Bore 2	2.656 Inch 67.462 Millimeter
Overall Height with Aligning Washer	0 Inch 0 Millimeter
Height	1 Inch 25.4 Millimeter
Bore 1	2.625 Inch 66.675 Millimeter



EDB BEARING CORP.

Outside Diameter	4.344 Inch 110.338 Millimeter
------------------	------------------------------------